



The Belfast City Hospital located in Northern Ireland, is a 900 bed modern university teaching hospital providing local acute services and key regional specialities.

Designed to the highest building and infection control standards and to help achieve these standards, EZ-Spouts™ have been installed to provide the ability to carry out and monitor hygiene purges.

## Features:

- ▶ 316 Stainless Steel body, internal waterway and full bore outlet to reduce bio-film build up
- ▶ Removable spout for servicing, autoclaving and exchange
- ▶ No-touch operation
- ▶ Automatic Purge and Chlorination options
- ▶ Anti-vandal mode on/off and adjustable run time
- ▶ USB connection to upload real-time data to PC, including; total run time, total number of operations and more

## Point of use filter

- ▶ Quick connection and instant protection against Legionella and other bacteria
- ▶ Validated to 0.2µm filter membrane
- ▶ Pre-sterilised and ready to use

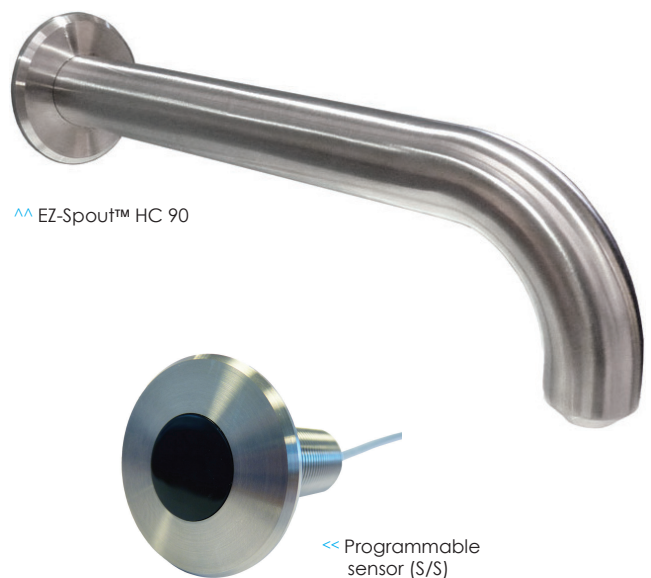
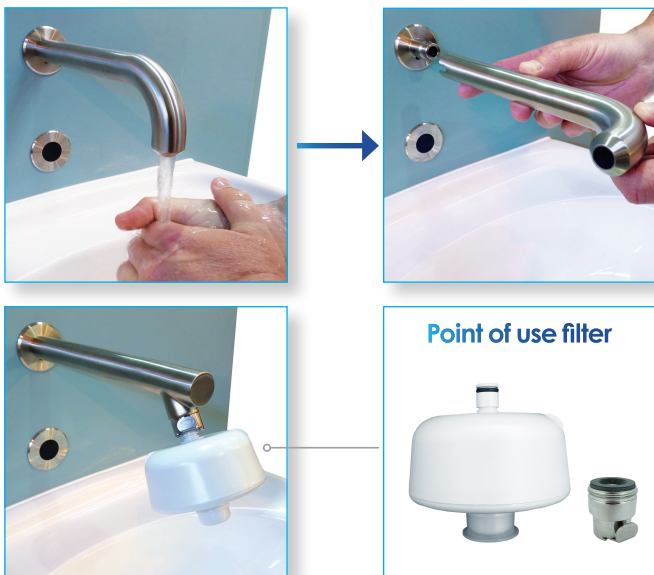

For more information on our products and services, please contact the sales team on +44 (0)2890 461755